

Wiring Diagram

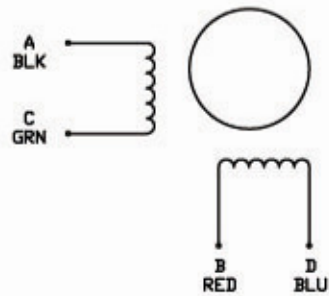

SPECIFICATIONS

1	Number of Phase	2
2	Step Angle	1.8° ±5%
3	Holding Torque	16 kg. cm
4	Voltage	4 VDC
5	Current	2.0 A
6	Phase Resistance (20°C)	2.0 ±10% Ω
7	Phase Inductance (1KHz)	6.3 ±20% mH
8	Rotor Inertia	432g · cm ²
9	Insulation Resistance	100M Ω 500VDC
10	Insulation Class	B (130°C)
11	Ambient Temperature	-20°C to 50°C
12	Ambient Humidity	15% to 95%
13	Motor Weight	Approx 0.9 kg
14		

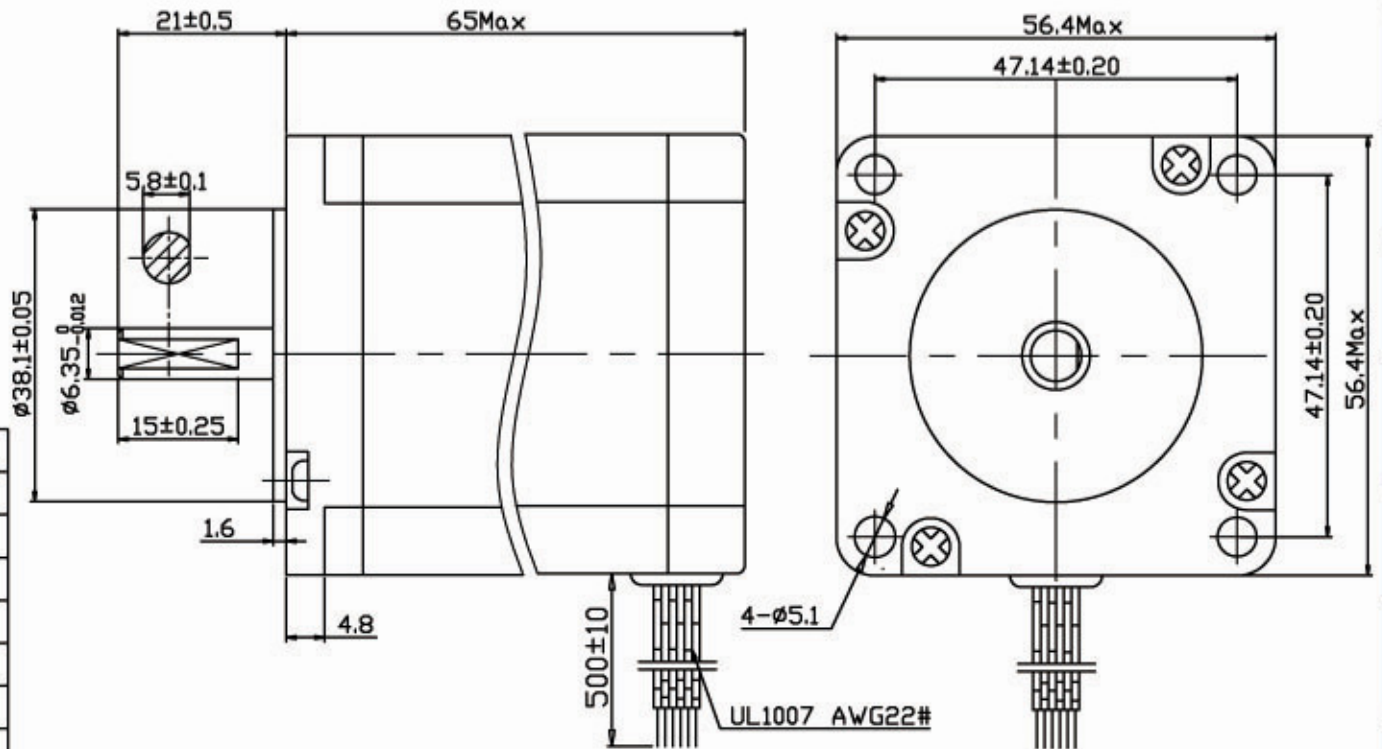

EXITING SEQUENCE (2 PHASE)

STEP	A	B	\bar{A}	\bar{B}	CCV
1	+	+	-	-	↑
2	-	+	+	-	↑
3	-	-	+	+	↑
4	+	-	-	+	↑

Directional arrows: CW (Clockwise) and CCW (Counter-clockwise).

Unit:mm

First angle method



Tolerances for linear and angular dimensions without individual tolerance indications
GB/T 1804-m eqv ISO 2768-1:m

Geometrical tolerances for features without individual tolerance indications
GB/T 1184-k eqv ISO 2768-2:k

DESIGN

CHECK

TECHNOLOGY

STANDARD

APPROVE



TYPE: HYBRID STEPPING MOTOR SCALE XX Rev. 1.0 SHEET 1 OF 1

Model: 23HS57-2016A

V1.0 HTPS1603232 20160323

REV. REVISION RECORD DATE

UNLESS OTHERWISE SPECIFIED NAMES SIGNATURE DATE